

## "D" PROFILE - TOOL LIST ONLY; EXTRUSIONS NOT HELD IN STOCK

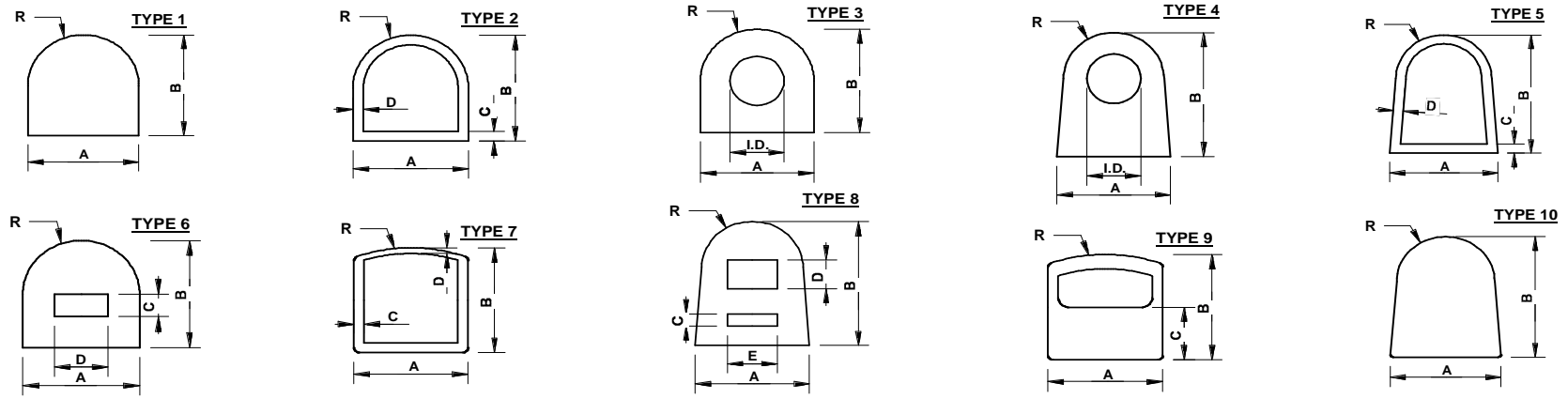

DATE: 25.08.09 ISS5 (UP TO DIE 2761/SB)

DIE #	TYPE	HARDNESS	A	B	C	D	E	I.D	R
809/SW	1	65	2	1					1
1395/SB	1	80	2	2					1
1460/SB	1	80	2.34	2.34					1.17
1460/SB	1	80	2.41	2.46					1.2
2604/SB	2	45	3.2	2.55	1	0.5			2.6
2605/SB	1	SIL24	3.2	2.8					
925/SB	3	80	3.2	4				1.5	1.6
1693/SB	1	70	4	6					2
1709/SB	1	70	4	8					2
2212/SB	3	55	4.25	4.5				2.9	2.13
714/SB	1	60	4.5	5.8					2.25
1731/SB	1	70	5	7					3.5
1181/SB	2	60	5	7	1	1			2.5
2213/SB	1	50	5	10					2.5
2757/SB	1	55	5	10					
1433/SB	3	30	5.2	5.2				2.54	2.6
1714/SW	4	60	5.4	6				2	2.2
995/SB	3	60	6	6				3	3
669/SB	1	70	6	6					3

## "D" PROFILE - TOOL LIST ONLY; EXTRUSIONS NOT HELD IN STOCK

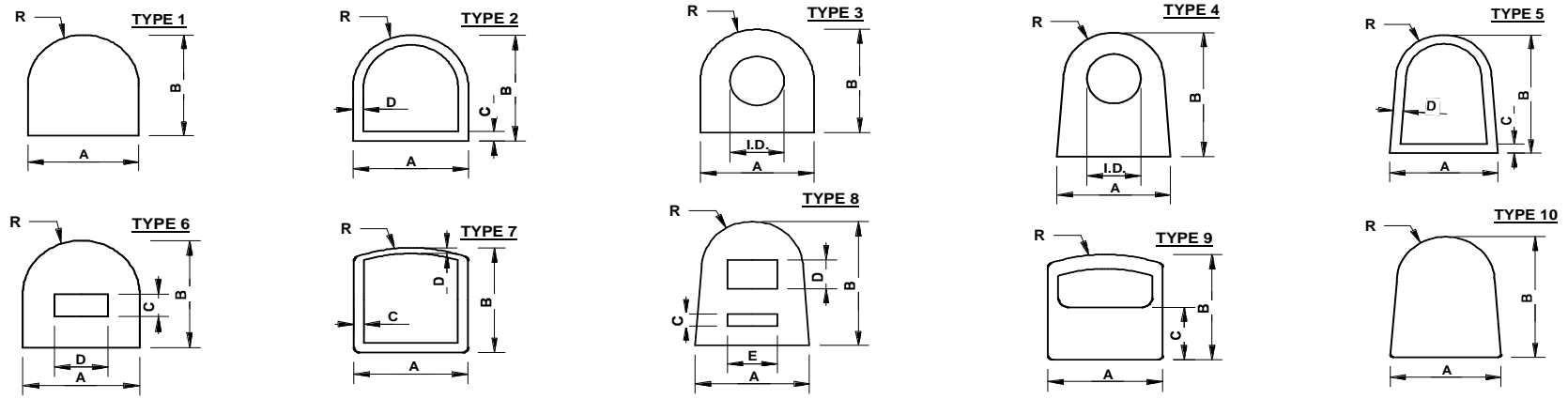

DATE: 25.08.09 ISS5 (UP TO DIE 2761/SB)

DIE #	TYPE	HARDNESS	A	B	C	D	E	I.D	R
1232/SW	3	60	6	6.5				2.5	3
1274/SB	1	40	6	7.5					3
1755/SB	1	16	6	8					3
1756/SB	1	60	6	8					3
1350/SW	3	60	6	9				1.5	3
26/SB	1	60	6.35	7.14					3.18
2283/SB	2	60	6.5	6	0.5	0.5			
1277/SB	1	60	7	5					3.5
2277/SB	1	60	7	9					
2166S/B	2	60	7.5	5.5	0.5	0.5			3.75
188/SW	1	80	7.5	9.53					3.75
58/SB	1	60	8	7					4
1366/SB	1	60	8	8					4
1128/SB	3	60	8	9				4	4.5
1771/SB	1	75	8	10					4
2033/SB	1	70	8	10					4
2761/SB	1	60	8	12					
2650/SB	1	60	8	13					
1754/SB	3	70	8.2	9				3	4.1

## "D" PROFILE - TOOL LIST ONLY; EXTRUSIONS NOT HELD IN STOCK

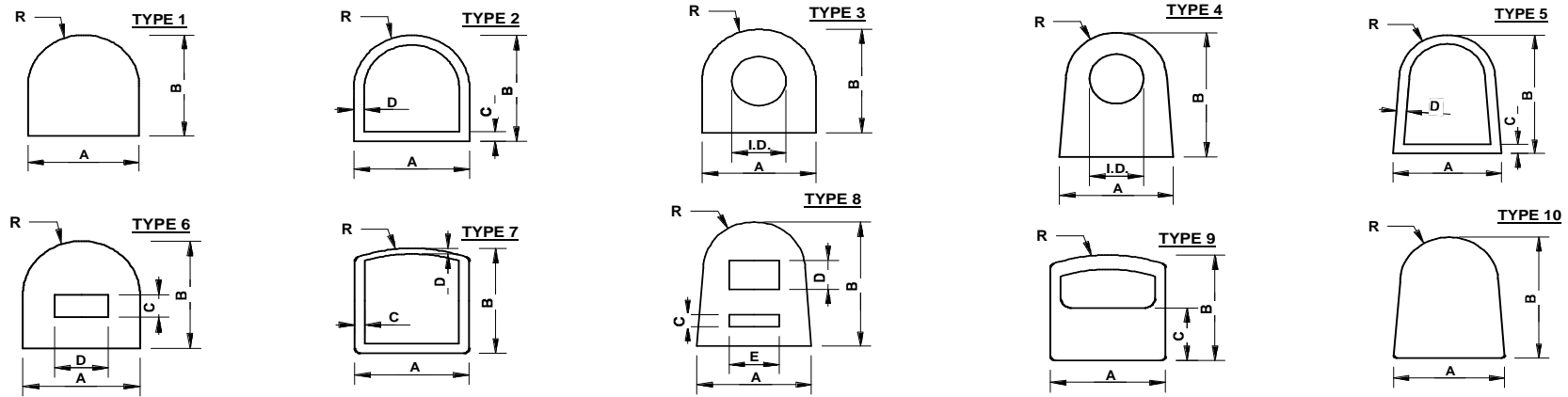

DATE: 25.08.09 ISS5 (UP TO DIE 2761/SB)

DIE #	TYPE	HARDNESS	A	B	C	D	E	I.D	R
52/SB	1	50	8.2	18					4.1
829/SB	1	60	8.75	12.4					4.38
1240/SB	3	40	9	9				3	4.5
906/SB	1	60	9	9					4.5
1083/SB	1	55	9	9					2.5
2596/SB	1	60	9	12					
885/SB	1	55	9.5	9.5					4.75
147/SW	9	40	9.5	12	4.5				6.3
2736/SB	1	50	9.5	12.5					
2639/SB	1	30	10	3					
1186/SW	1	35	10	5					5
2642/SB	1	50	10	5					
2110/SB	2	60	10	6	1.5	1.5			5
2151/SB	2	60	10	7	1	1			5
1154/SB	1	60	10	8					5
1126/SB	3	60	10	10				4	5
1835/SW	3	60	10	13				3	5
1989/SB	1	60	10	13					5
2220/SB	3	50	10	13				3	5

## "D" PROFILE - TOOL LIST ONLY; EXTRUSIONS NOT HELD IN STOCK

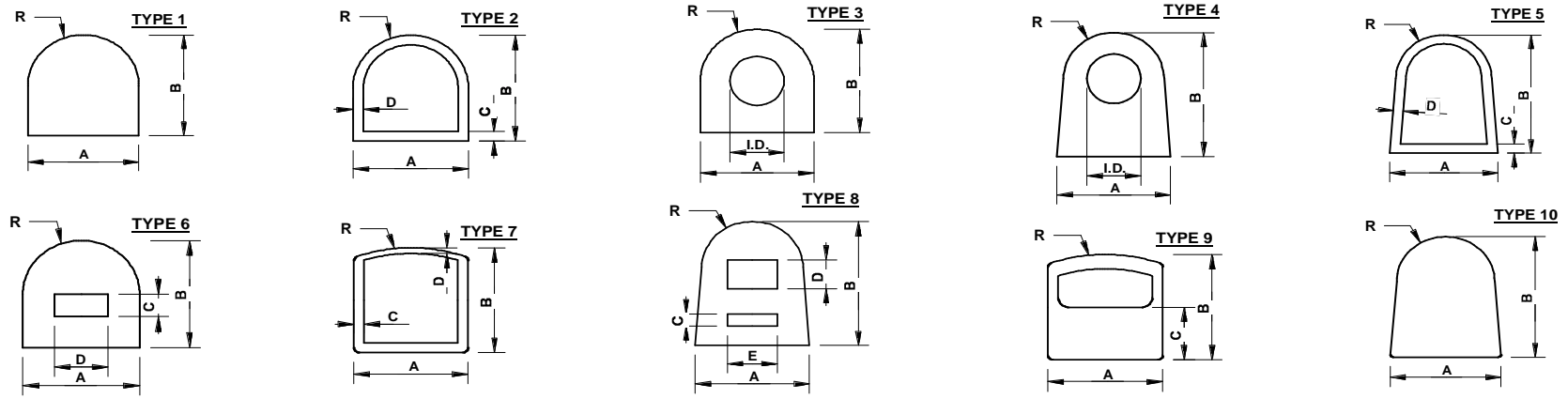

DATE: 25.08.09 ISS5 (UP TO DIE 2761/SB)

DIE #	TYPE	HARDNESS	A	B	C	D	E	I.D	R
1790/SB	2	60	10	16	1	1			5
2372/SB	3	45	10	19				4	
1394/SB	2	50	10	21	16	16			5
416/SB	3	70	10.5	5.25					
2612/SB	1	55	11	8					
905/SB	1	60	11	12					5.5
1334/SB	1	60	11	13.3					5.5
2061/SB	1	60	11	15					5.5
1447/SB	1	40	11.11	12.7					3.2
245/SB	1	80	12	10					6
593/SB	1	45	12	12					6
607/SB	1	70	12	12.3					6
1586/SB	3	55	12	14				8	6
1705/SB	3	55	12	14				5	6
1093/SW	5	60	12	15	3	2.5			5.3
1823/SW	5	50	12	15	2.5	2.5			5
1048/SB	1	60	12	16					6
2043/SB	8	45	12	16	2	3	7		5

## "D" PROFILE - TOOL LIST ONLY; EXTRUSIONS NOT HELD IN STOCK

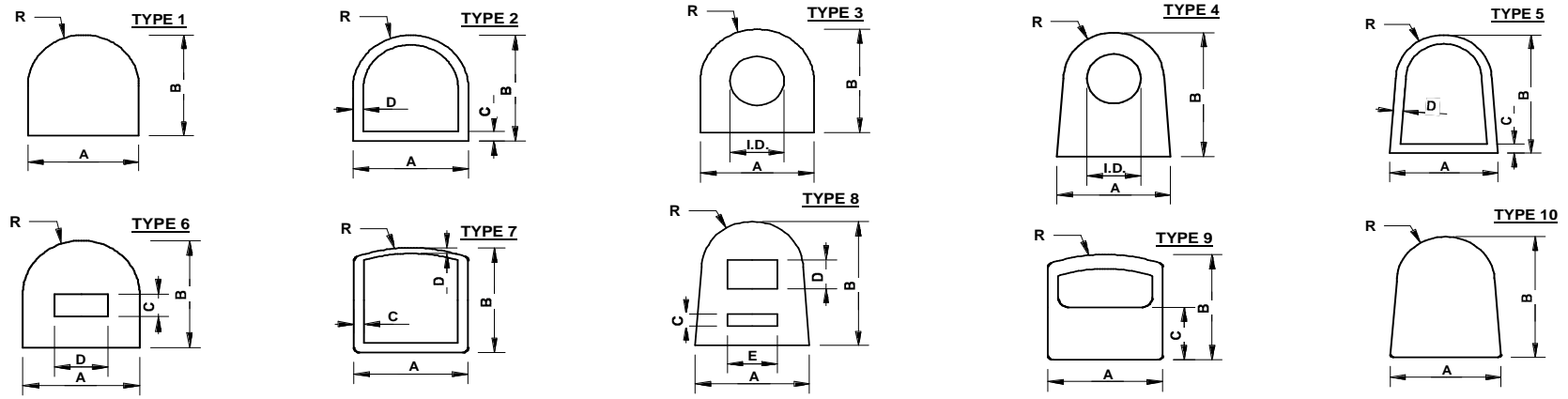

DATE: 25.08.09 ISS5 (UP TO DIE 2761/SB)

DIE #	TYPE	HARDNESS	A	B	C	D	E	I.D	R
996/SW	6	65	12.1	10.5	5.5	4.7			6
30/SB	1	80	12.25	12.75					6.15
631/SW	3	30	12.5	25				5.5	6.25
287/SB	1	40	12.7	14.29					6.35
61/SB	1	60	12.7	19.05					6.35
2765/SB	1	75	12.8	12					
2766/SB	1	75	12.8	12					
2663/SB	1	65	12.8	12					
1698/SB	1	60	13	11					6.5
762/SB	1	60	13	13					6.5
1555/SB	1	60	13	20					6.2
1444/SB	1	30	13	21					6.5
1285/SB	3	60	13	24				5	6.5
1132/SW	1	60	13	25					7
387/SB	1	50	14	11					7
2365/SB	1	45	14.46	6.71					
33/SB	2	40	15	12	2				7.5
886/SB	3	50	15	13.7				4	7.5
1433/SB	1	60	15	14					7.5

## "D" PROFILE - TOOL LIST ONLY; EXTRUSIONS NOT HELD IN STOCK

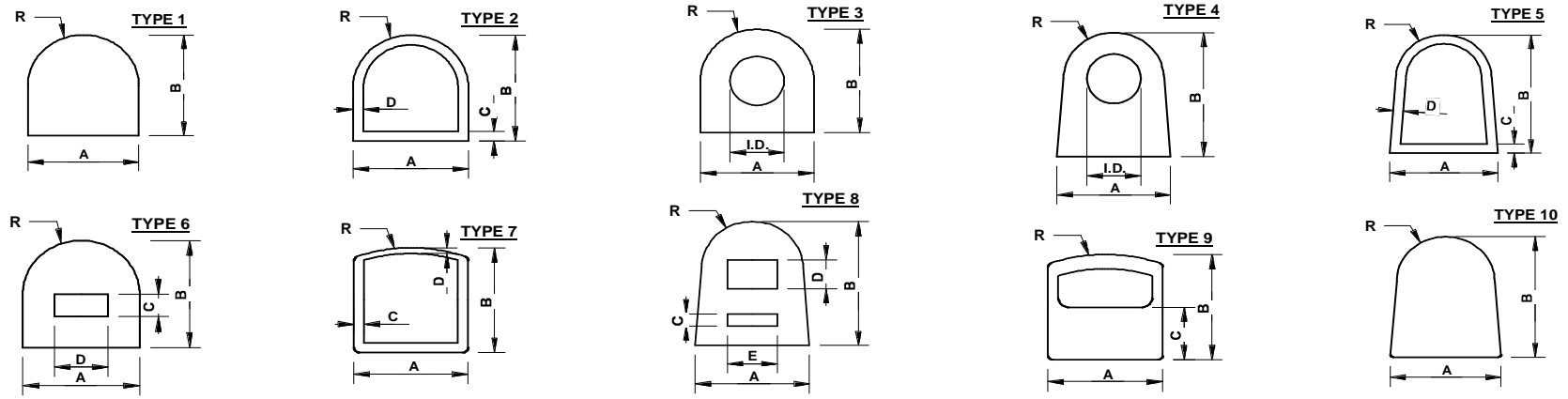

DATE: 25.08.09 ISS5 (UP TO DIE 2761/SB)

DIE #	TYPE	HARDNESS	A	B	C	D	E	I.D	R
1767/SB	1	60	15	15					7.5
2049/SB	1	65	15	15					7.5
1954/SB	1	60	15	15.5					7.5
2731/SB	1	50	15	24					
1601/SB	2	60	15.2	10.4	1	1			7.6
1280/SW	7	50	15.5	12	2.5	1.5			20
482/SB	2	60	16	8	8				8
1955/SB	1	60	16	17					8
2106/SB	1	60	17	20					6
2741/SB	1	60	18	10.5					
1324/SB	1	65	18	13.5					9
572/SB	1	60	18	16					9
1250/SB	2	50	18.5	20	10.75			2.5	9.25
1957/SB	1	70	19	10					9.5
763/SB	1	50	19.05	15.88					9.52
1700/SB	1	55	19.1	8					9.85
1862/SB	1	60	19.3	19.4					13.64
1225/SW	2	60	20	9.5	2.25	2.25			10
1442/SB	2	60	20	12	5	5			10

## "D" PROFILE - TOOL LIST ONLY; EXTRUSIONS NOT HELD IN STOCK

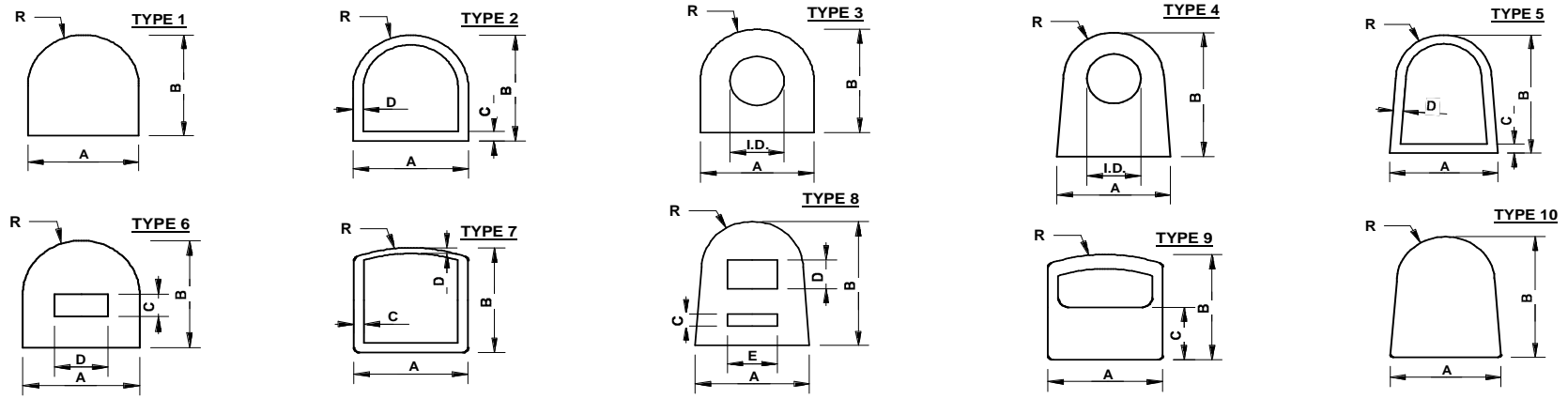

DATE: 25.08.09 ISS5 (UP TO DIE 2761/SB)

DIE #	TYPE	HARDNESS	A	B	C	D	E	I.D	R
1839/SB	1	65	21	11					6
671/SB	1	70	21.5	21.5					10.75
460/SB	1	70	21.5	25					10.75
44/SB	1	70	21.5	22					10.75
244/SB	2	60	25	6					12.5
1675/SB	10	50	25	15					15
1056/SB	1	50	25	28					12.5
407/SW	2	60	25.4	25.4	3.2	3.2			12.7
283/SB	2	60	25.4	25.4				3.18	12.7
207/SB	1	60	26	29					13
1650/SB	1	60	27	30					13.5
554/SB	1	60	29	20.3					14.5
1748/SB	1	60	30	30					15
710/SB	3	60	31.75	25.4	9.53			9.53	15.88
559/SB	1	60	33	20					16.5
1816/SW	3	60	35	35				18	17.5
2302/SB	2	60	37	23.5	3.5	3.5			37
196/SB	1	70	40	30					20

**"D" PROFILE - TOOL LIST ONLY; EXTRUSIONS NOT HELD IN STOCK**

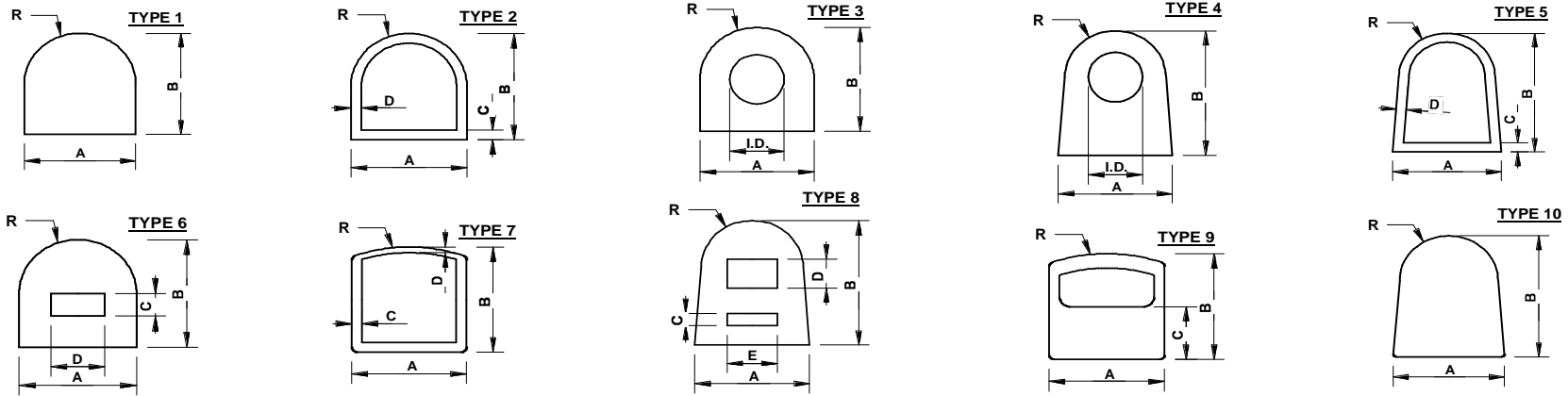

DATE: 25.08.09 ISS5 (UP TO DIE 2761/SB)

DIE #	TYPE	HARDNESS	A	B	C	D	E	I.D	R
470/SB	2	70	48	25					24